

## INSTALLATION MANUAL

# **WINDSCREEN V730 - BIARRITZ**

## Index

	page
Content package	2
Required tools	2
Important before mounting	3
1. Installing Biarritz windscreen	4
1.1 Portable windscreen	5
1.2 Ongoing installation with footplate	7
1.3 Installation on a deck	10
1.3 Inground installation with loose upright	11
2. Linking Biarritz windscreen	13
2.1 Linking blind	14
2.2 Linking hook	15
3. Accessoires	17
3.1 Hinge	17
3.2 Wall installation	19
3.3 Handle	20
3.4 Ground lock	20
4. Overview possibilities Biarritz	21

## Biarritz basic windscreen

Standard version, including:

- Clear glass 5mm, hardened
- Covering caps

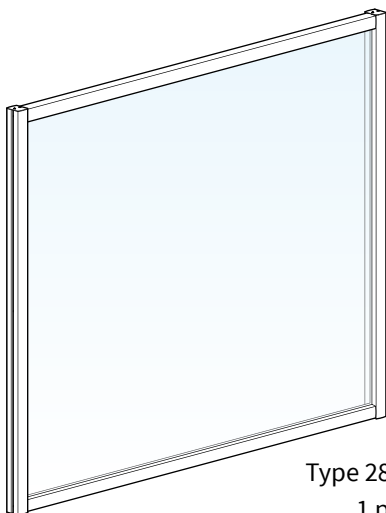

Type 28.731  
1 panel

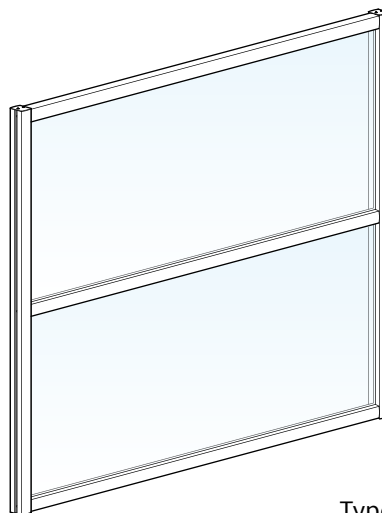

Type 28.732  
2 panels

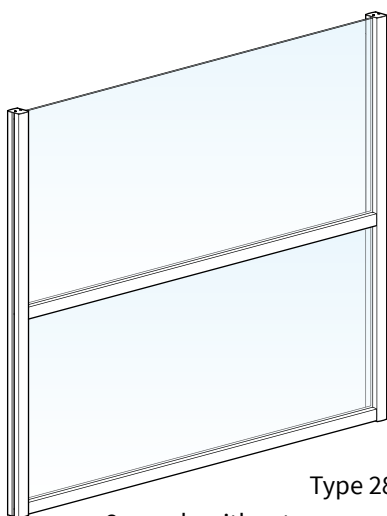

Type 28.722  
2 panels without upper profile

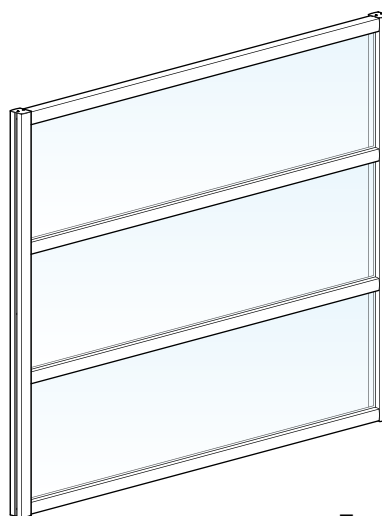

Type 28.733  
3 panels

## Required tools

- Drill
- Masonry drill 14 mm (depending on installation)
- Open end wrench or ratchet 17
- Phillips head screwdriver
- Allen key set
- Tape measure
- Level
- Pencil
- Installation instruction

## Important before installation

### General warning

Installation of this product is at your own risk. Use this installation instruction only as an assistance and only with the installation of this specific product. If you can not install this product yourself, you can always opt for professional installation. Your dealer's installation team is always ready to assist you.

### Please be aware of damages

Do not use a knife or any other sharp object while opening the packaging. The product could get damaged. Place the product on a soft surface. Please take care while drilling. Drilling waste may cause damages.

### Check the (installation) surface

For installing the Biarritz windscreen, the surface must meet certain requirements:

- The windscreen may only be installed on a solid surface.
- If your Biarritz windscreen is mounted fixed onto the surface, then should this surface have a solid concrete foundation.
- Note if there are no protruding parts or other obstacles in the way.
- For the installment of the windscreen, it is important that the surface is horizontal level.
- If the floor is not level, you can opt for extended uprights that are sunk into the bottom of the surface.



### Warning!

### The Biarritz is not suitable as a balustrade!

A balustrade is a low fence or wall that with a difference in height, people, who are located on the high side, helps to protect against falling. A balustrade is obliged with a height difference of 1 meter.

The Biarritz windscreen should never be used as a substitute for a balustrade. It must only be placed against a balustrade, on the high side!

With a height difference of 1 meter or more, the windscreen should be implemented with layered safety glass.

## 1 Installing Biarritz windscreen.

The Biarritz windscreen can be installed on a surface in three different ways:

1. Portable
2. Onground, fixed installation with footplate
3. Inground, fixed installation with separate upright

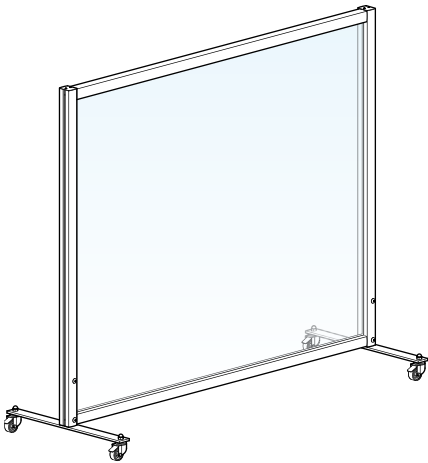

**Biarritz with portable foot**

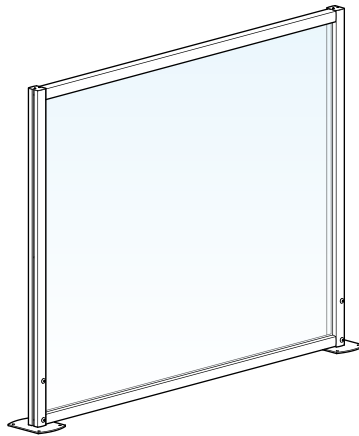

**Onground installation with footplate**

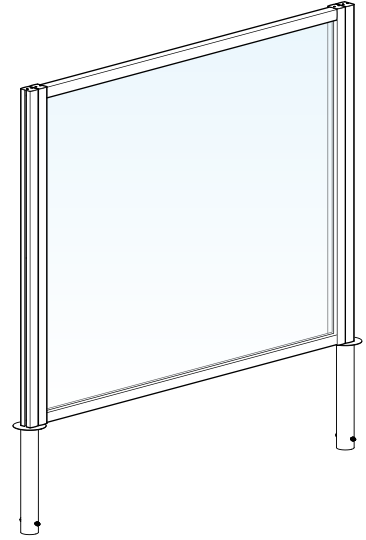

**Inground installation with separate upright**

*Figure 1.1 Installing Biarritz*

## 1.1 Portable windscreen

If you have a portable Biarritz windscreen, you can place it in any required position as long as the surface is firm and level.

Portable feet come in 4 different versions:

- Indoor foot
- Basic foot
- Raised foot
- Reinforced foot

Version b, c and d is also available with wheels, with or without brake.

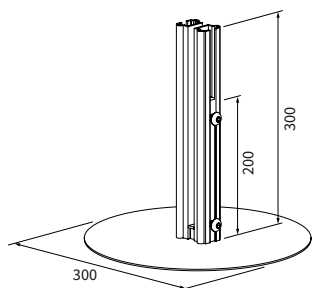

**Indoor foot**

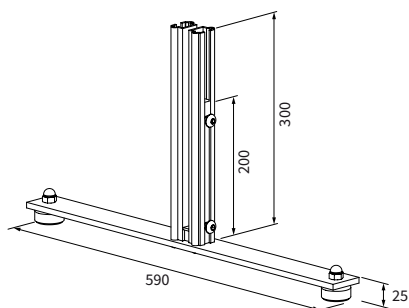

**Basic foot**

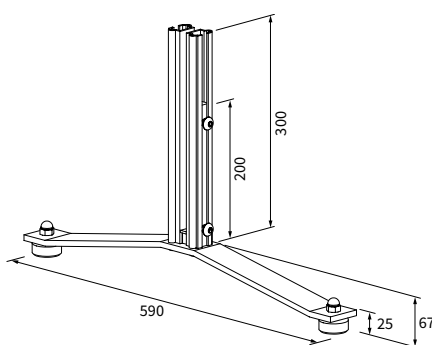

**Raised foot**

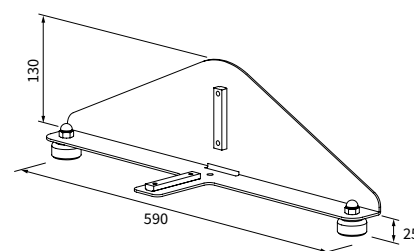

**Reinforced foot**

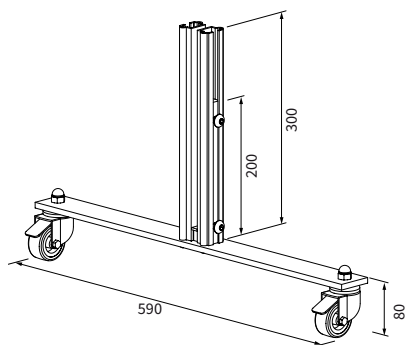

**Basic foot with wheels**

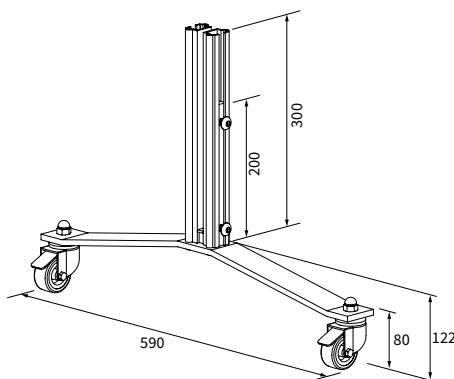

**Raised foot with wheels**

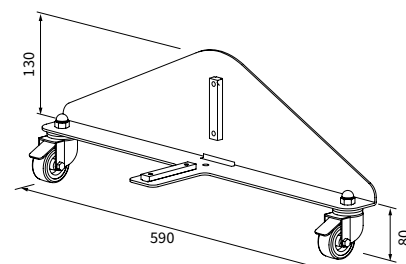

**Reinforced foot with wheels**

Figure 1.2 Measurements portable feet

Sizes in mm

### Installation basic foot and raised foot

Follow below steps for installation:

1. Slide the connecting strip in the profile on the left- and right foot.
2. Place the windscreen over the profile onto the foot. Make sure the predrilled holes in the upright of the windscreen are on the same side as the connecting strip.
3. Place two screws in the predrilled holes in the upright an connecting strip to secure the windscreen to the foot. Check if the windscreen is level, horizontally as well as vertically. Tighten the screws.

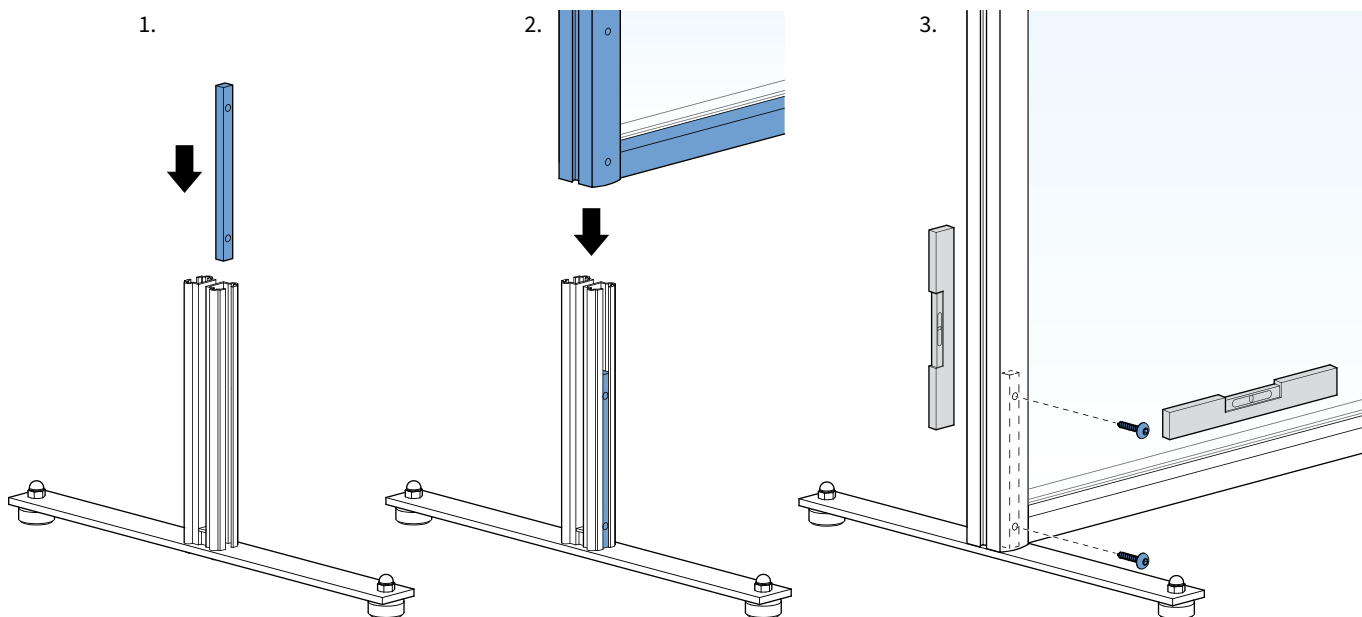

Figure 1.3 Installation basic foot

### Installation reinforced foot

Remark! The reinforced foot is already installed during the assemble.

If the foot is reordered, please follow the installation steps below.

1. Demount the vertical profile at one side of the windscreen.
2. Demount the horizontal connection-strips of the reinforced foot and slide these in the lower horizontal profile to the right position.
3. Reinstall the vertical profile and slide the windscreen over the vertical connection-strips to the reinforced foot. Screw the foot from the bottom and the connection-strips to the windscreen

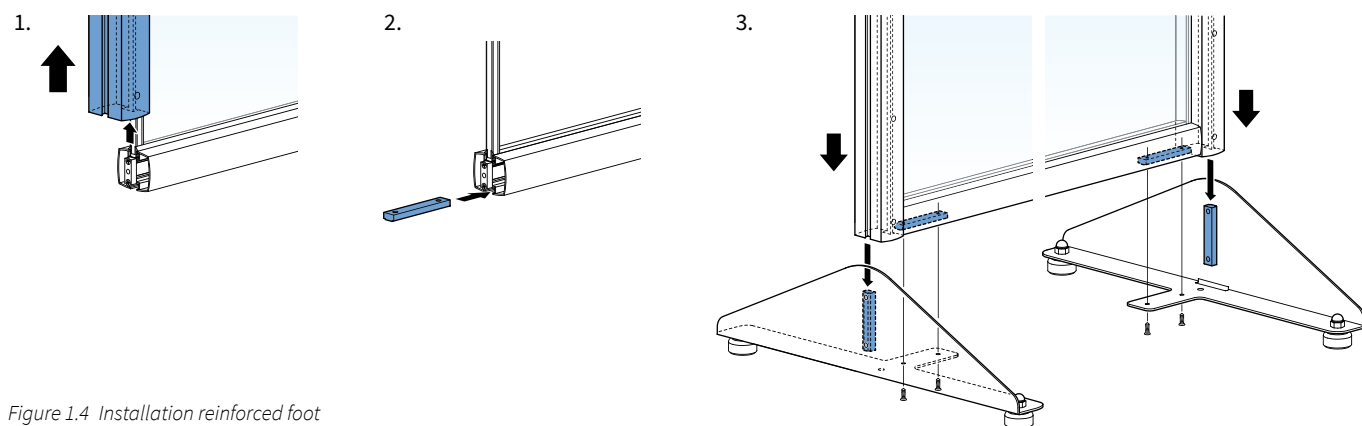

Figure 1.4 Installation reinforced foot

## 1.2 Ongoing installation with footplate

Ongoing installation is done by using a footplate which is mounted onto a concrete surface. The footplates are mounted onto the ground with lag screws.

The fixed feet comes in two different versions:

- Ground footplate
- Wall footplate

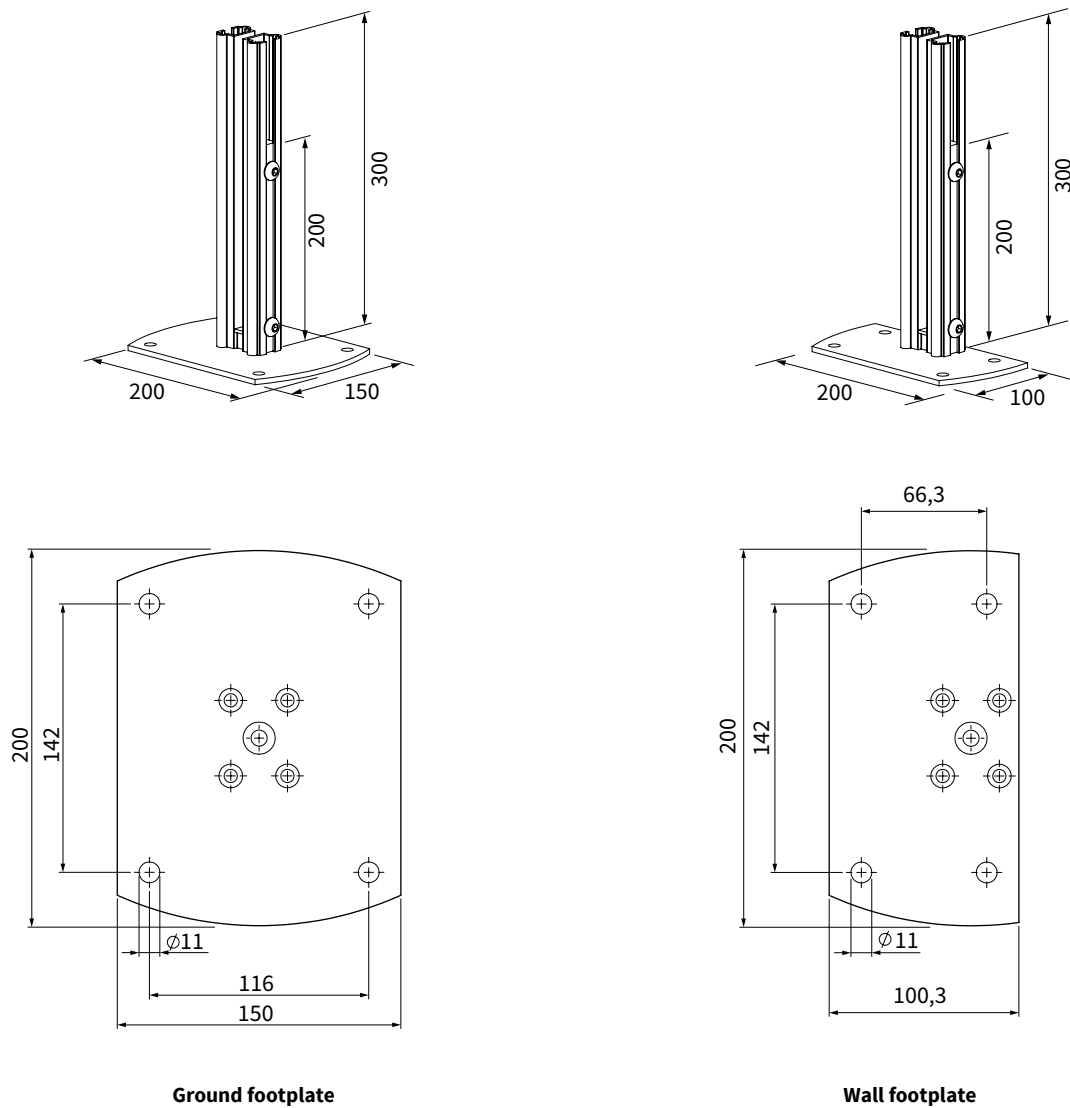

Figure 1.5 Measurements footplates

Sizes in mm



## Installation

Follow below steps for installation:

1. Slide the connecting strip in the profile onto the left- and right footplate.
2. Place the windscreen over the profile onto the footplate. Make sure the predrilled holes in the upright of the windscreen are on the same side as the connecting strip.
3. Place the windscreen in the desired position.  
Drill holes into the foundation with a 14mm drill and mount the footplates of the windscreen with plugs and lag screws.
4. Place two screws in the predrilled holes in the upright and connecting strip to secure the windscreen onto the footplate. Check if the windscreen is level, horizontally as well as vertically. Tighten the screws.

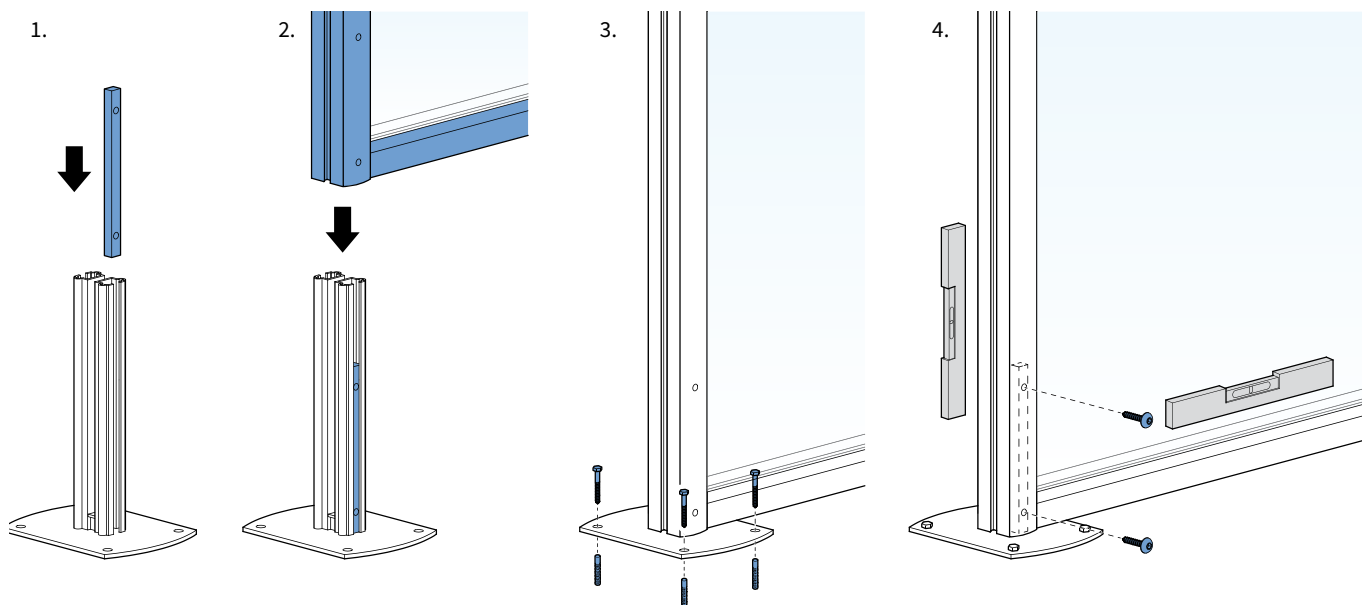

Figure 1.6 Onground installation

Instead of lag screws you can also use wedge bolts for the installation of the footplates.

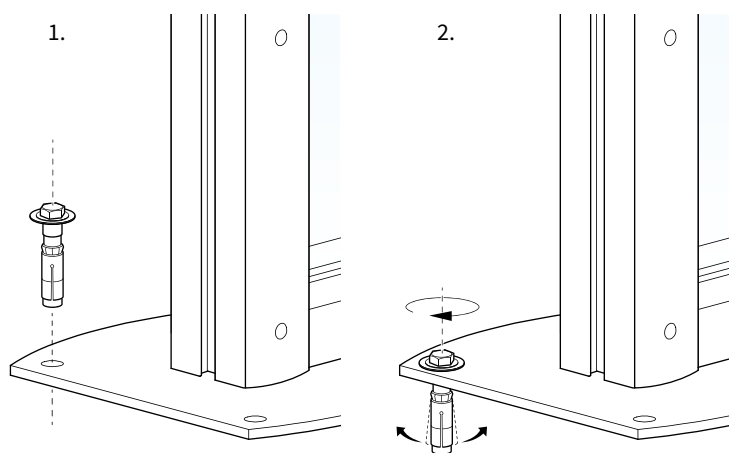

Figure 1.7 Installation with wedge bolts

### Compensating height difference in installation surface

To compensate for small height differences in the surface, it is possible to adjust the height of the connecting strip in the profile. The margin is (x) 100 mm.

Follow below steps for installation:

1. Slide the connecting strip in the profile onto the left- and right footplate.
2. Place the windscreen over the profile onto the footplate. Make sure the predrilled 2. holes in the upright of the windscreen are on the same side as the connecting strip. Place two screws in the predrilled holes in the upright and in the connecting strip. Do not tighten the screws yet!
3. Place the windscreen on the required height (x). Make sure the windscreen is completely level, horizontally as well as vertically. Now tighten the screws.
4. Drill holes in the foundation with a 14mm drill and mount the footplates of the windscreen with plugs and lag screws.

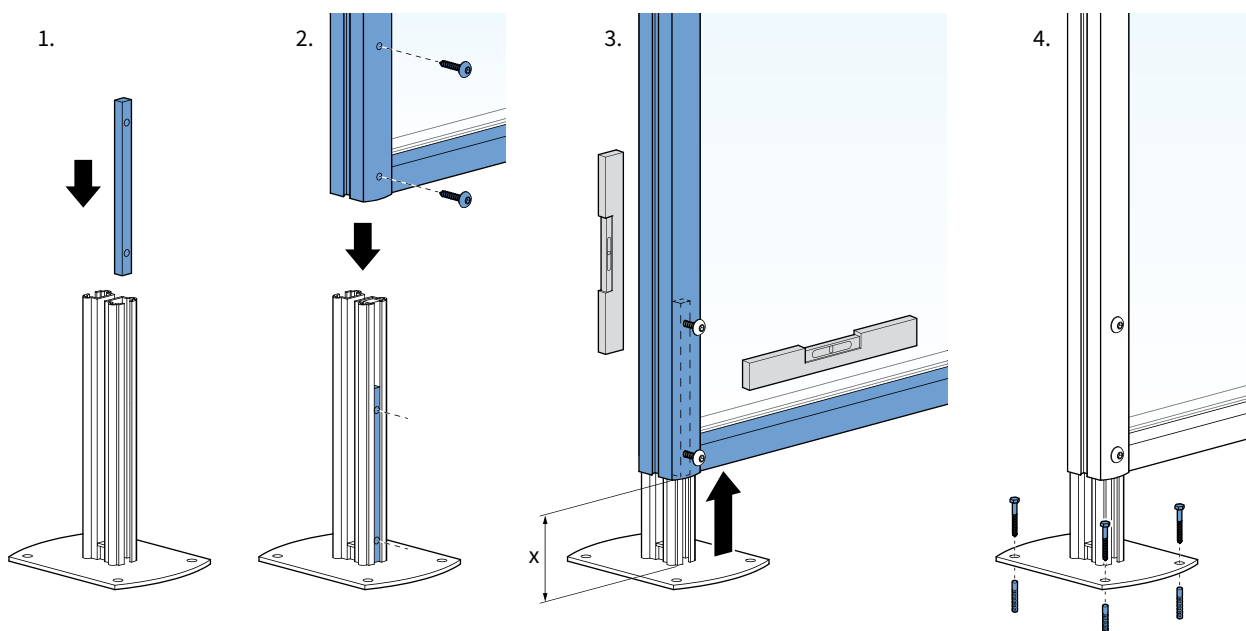

Figure 1.8 Adjustable in height



### Warning!

It is very important the footplates are completely level at both sides of the windscreen, horizontally as well as vertically.

### 1.3 Installation on a deck

If the Biarritz is placed on a decking, you can use the special decking footplates. These footplates make it possible to place the windscreen exactly on the edge of the decking.

The installation of the decking footplates works the same as in step 1.2 'Onground installation'. The necessary installation material depends on the material of your decking. To link several windbreaks, you need to use the loose upright, see 2. 'Linking the Biarritz windbreaks'. The decking footplates are available in six variants. The type of foot depends on the setting.

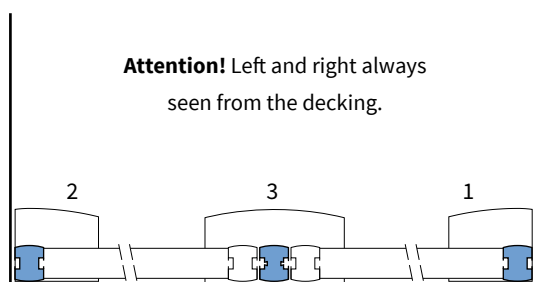

**Straight setting**

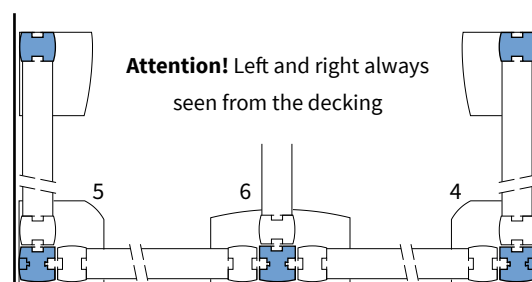

**U-setting**

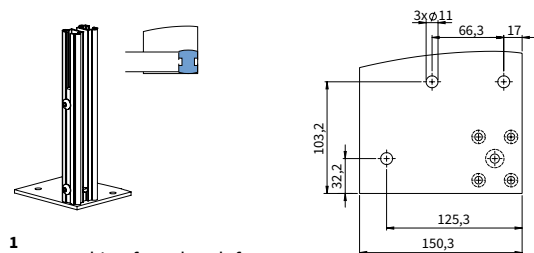

**1**  
V730 Decking footplate left

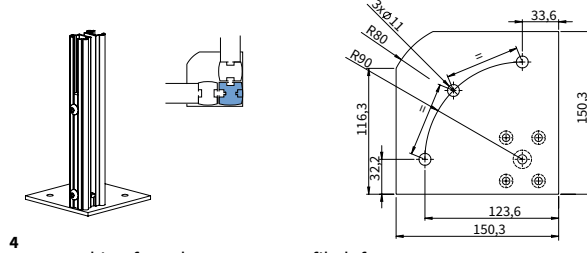

**4**  
V730 Decking footplate corner profile left

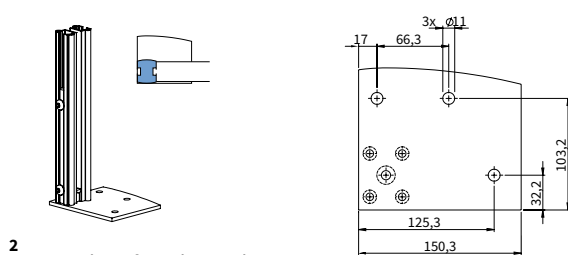

**2**  
V730 Decking footplate right

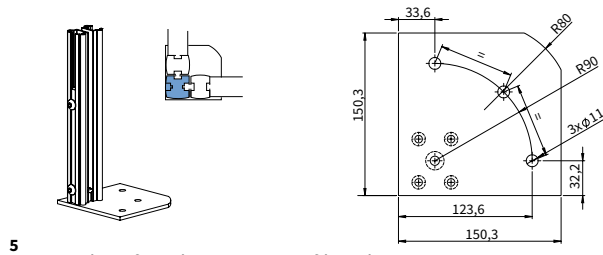

**5**  
V730 Decking footplate corner profile right

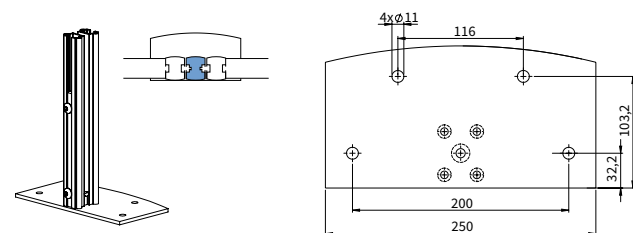

**3**  
V730 Decking footplate middle

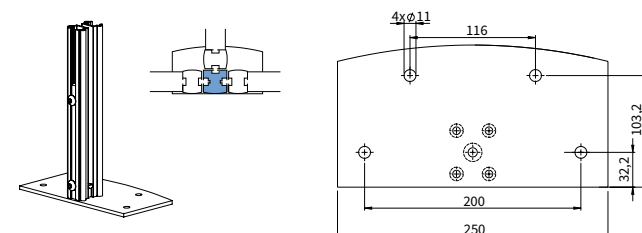

**6**  
V730 Decking footplate T-profile middle right

fig. 1.9 Different types of decking footplates.

### 1.3 Inground installation with separate upright

With inground installation the windscreen is linked to a loose upright with length (x) which is extended at the bottom with 450 mm. This extended part is shoved into a tube which is recessed mounted into the ground. A covering plate (a) creates a nice cover on the floor.

The separate upright comes in three versions:

- a. In-between profile
- b. Corner profile
- c. T-profile

The profile choice depends on the way the windscreen is linked (see page 12 'Linking Biarritz windscreen').

With the upright with in-between profile comes an (inground) tube with a diameter of 80 mm.

With the upright with a corner- or T-profile comes an (inground) tube with a diameter of 90 mm.

The covering plates (a) come in three different diameters: Ø 150, 200 and 300 mm.

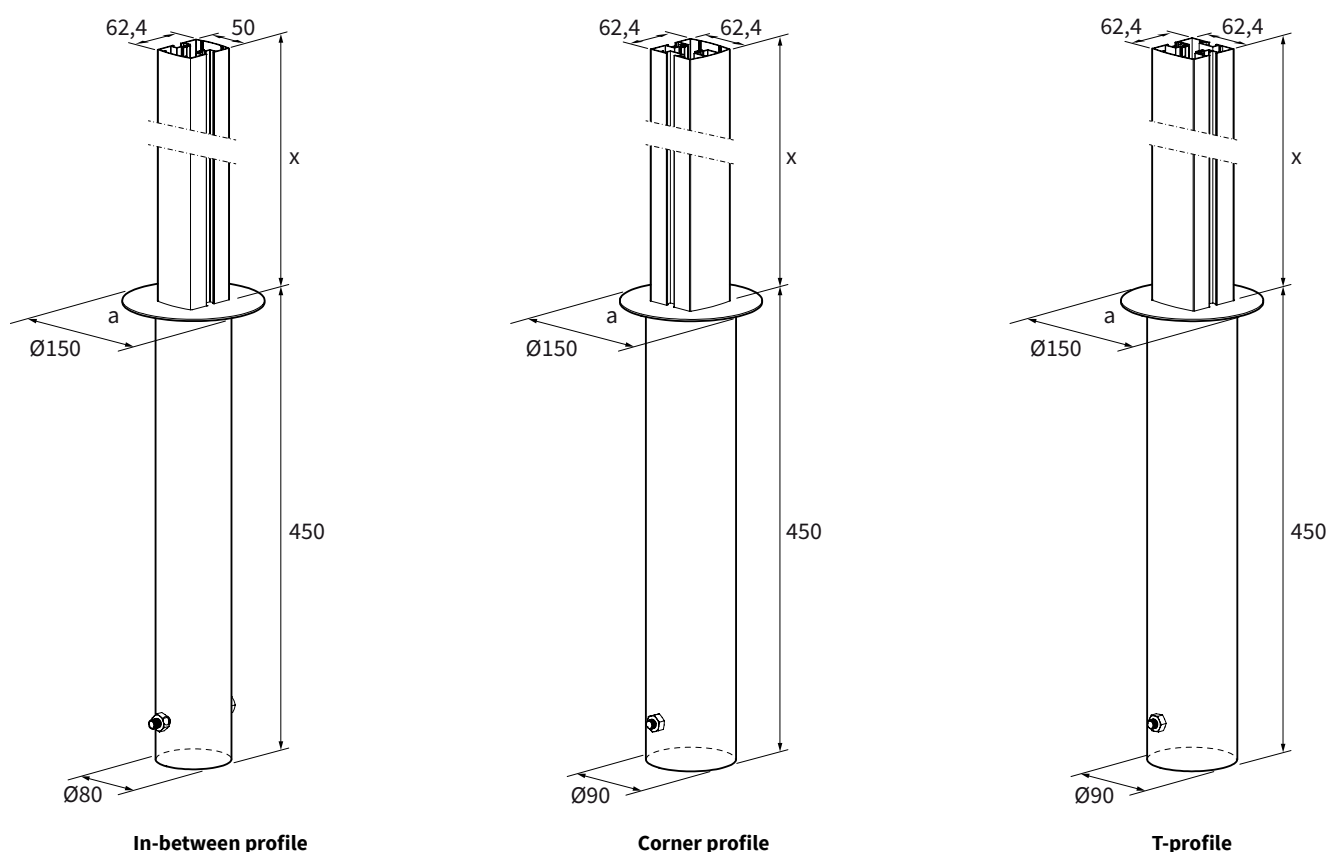

Figure 1.10 Measurements inground installation

Sizes in mm

## Installation

Follow below steps for installation:

1. Pour the tube fixed in a concrete base in the subsurface.



### Warning!

Make sure you place the right tube in the right upright.

Tube with Ø80mm for in-between profile, Ø90mm for corner- and T-profile..

2. Slide, from below, the covering cap (a) partially over the upright. Do this before you drop the upright into the tube!



### Warning!

Keep the covering cap level when you move it. When the covering cap is pushed crooked over the upright, damage may be caused..

3. Place the loose upright into the tube until the upright rests onto the transverse screw-thread.  
Repeat step 1 until 3 on the other side.



### Warning!

Make sure the tubes with loose uprights are at the correct distance from one another! This depends on the way you link the windscreens.

4. Link the windscreen on the left and right onto the loose upright. Check if they are level, horizontally as well as vertically. For linking instructions: see page 11 'Linking Biarritz windscreen'.

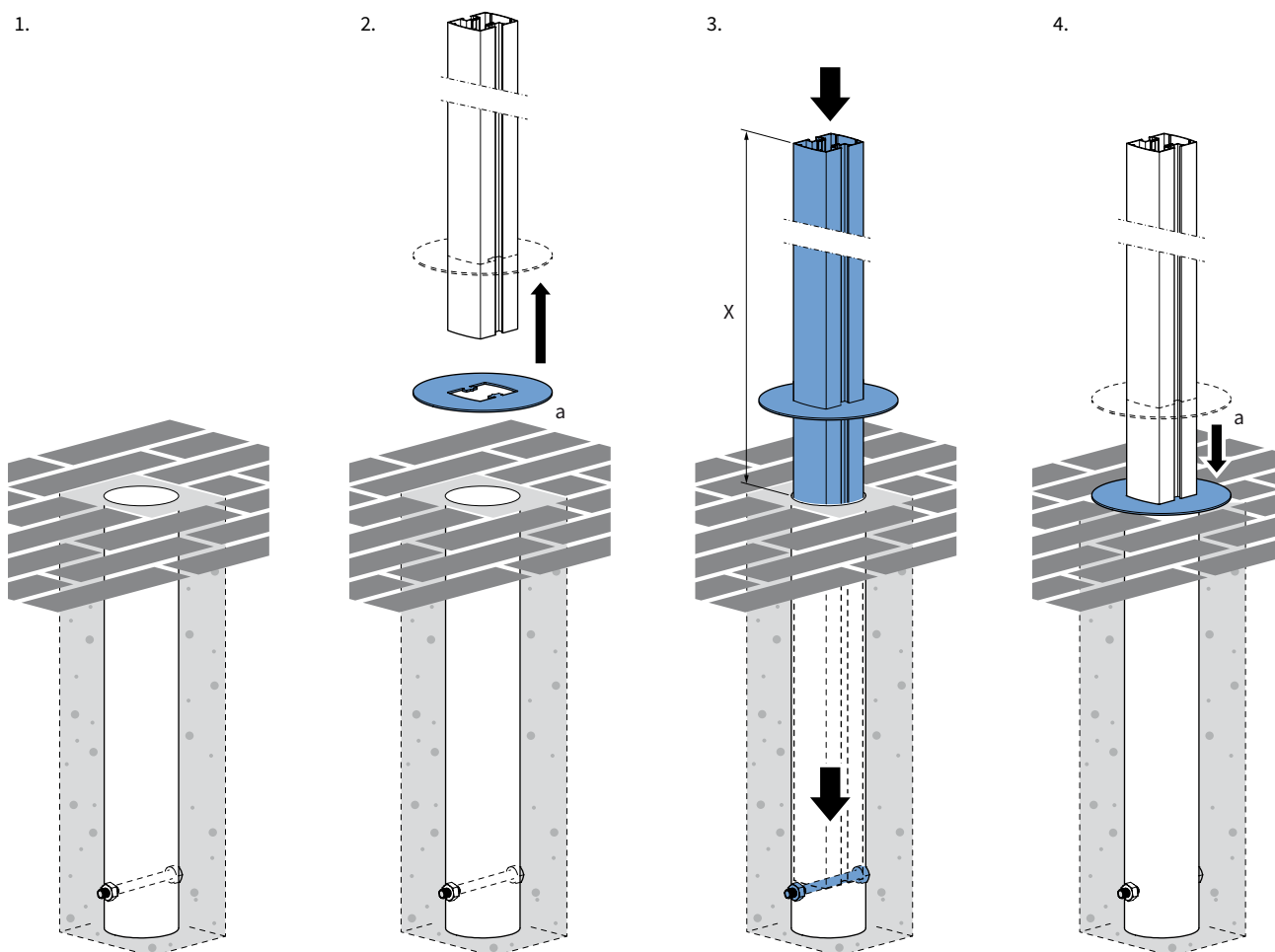

Figure 1.11 Inground installation

## 2. Linking Biarritz windscreen

It is possible to link multiple Biarritz windscreens. In this way you can make your windscreen as long as you like. There are two ways of linking:

### Standard linking

- Windscreen to windscreen
- Possible with all portable feet and footplates
- Only straight alignment possible
- Under linking at least one foot compulsory

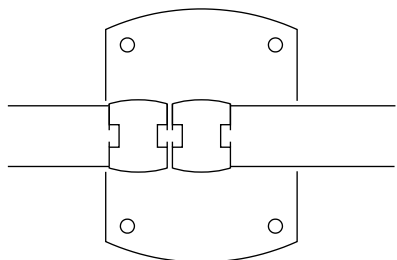
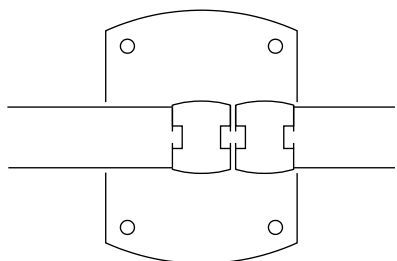
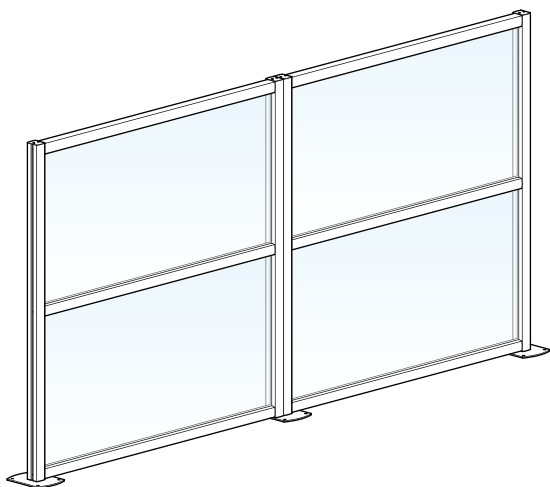
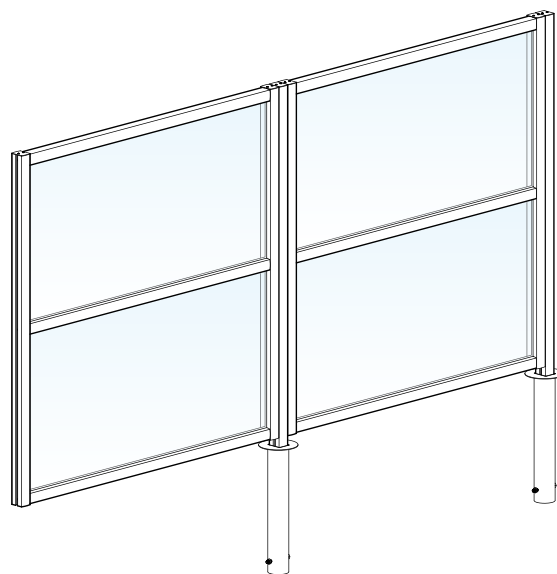

Figure 2.1 Standard linking

### Profile linking

- Windscreen to windscreen with separate upright in between
- Separate upright in three different profiles available
- Multiple alignments with 90° angles possible



#### In-between profile

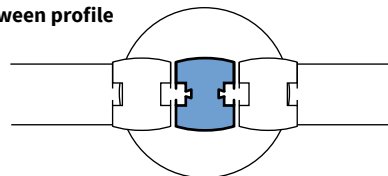

#### Corner profile

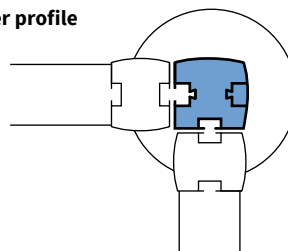

#### T-profile

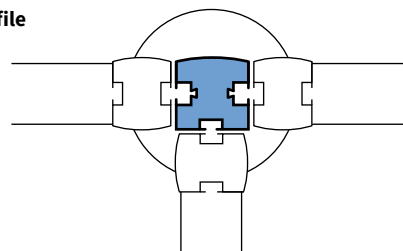

Figure 2.2 Profile linking

There are two types of linking:

1. Linking blind
2. Linking hook

## 2.1 Linking blind

The Biarritz windscreen can be linked blind by using coupling blocks. Linking blind means the coupling is fixed on to one another and is not visible. All coupling blocks are screwed in advance. Linking blind is possible with:

- a. Standard linking, in between two windscreens (see figure 2.1) or
- b. Profile linking, in between the windscreen and a loose upright (see figure 2.2, 2.3 and 2.4).

Follow steps below for installation:

1. Remove the covering caps at the topside of the windscreen and separate upright.
2. Slide the coupling blocks (a, b) in the slot of the windscreen and loose upright as indicated.
3. Measure the exact height at which the coupling blocks must be screwed. Tighten them with socket screws as indicated.
4. Slide the windscreen over the upright and make sure the coupling blocks fall into the slot, as well above as below. The windscreen is now linked blind.
5. Mount the covering caps at the topside of the uprights.

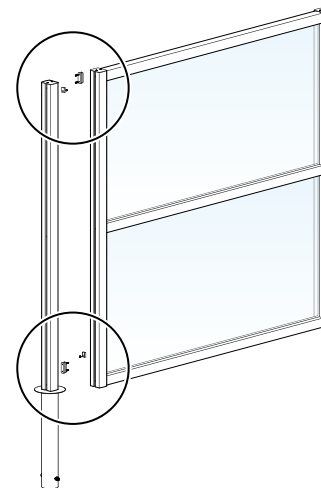

Figure 2.3 Location linking blind



### Warning!

With a Biarritz with reinforced foot linking blind is NOT possible!



### Attention!

To link a corner- or T-profile, you need a blank connection with longer allen screws.

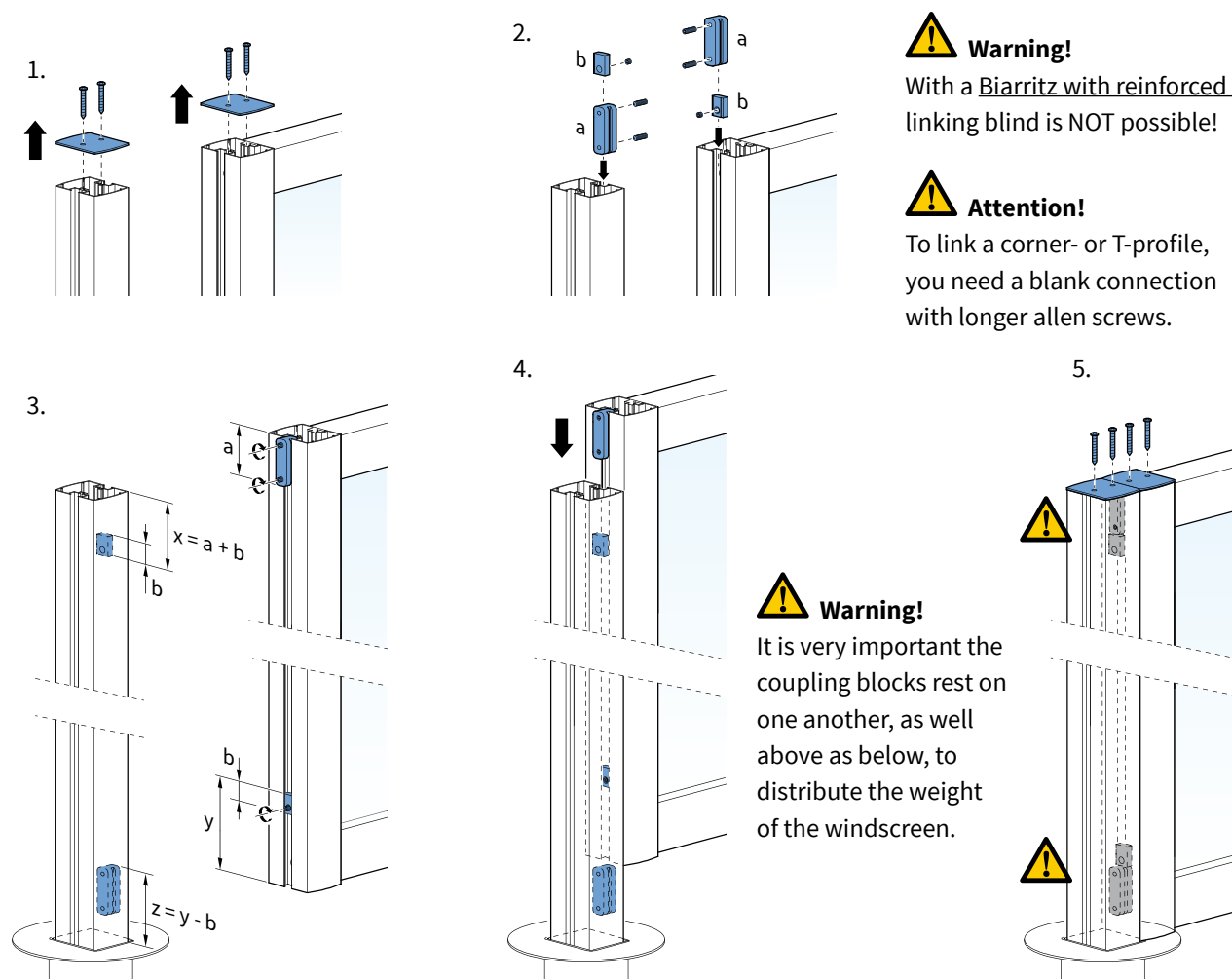

Figure 2.4 Installation linking blind



### Warning!

It is very important the coupling blocks rest on one another, as well above as below, to distribute the weight of the windscreen.

## 2.2 Linking hook

Linking hook is done by using brackets which hook into each other. Advantage of linking hook is that the windscreen can be disconnected easily.

Linking hook is possible with:

- Standard linking, in between two windscreens (see figure 2.1) or
- Profile linking, in between the windscreen and a separate upright (see figure 2.2, 2.5, 2.6 and 2.7).



### Warning!

With this linking method an interspace of 34 mm is required.



### Warning!

With a Biarritz with reinforced foot only linking hook is possible!

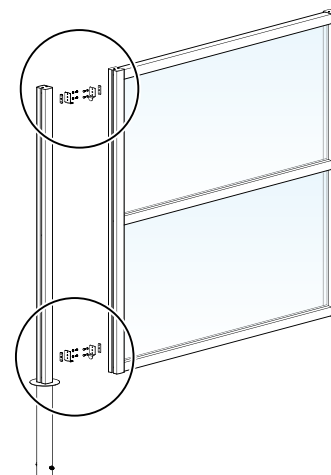

Figure 2.5 Location linking hook

The brackets with linking hook on can be mounted in different ways.

You can chose for **detachable installation** or **locked installation**.

For installation possibilities of the brackets see figure 2.6 below.

### Detachable installation

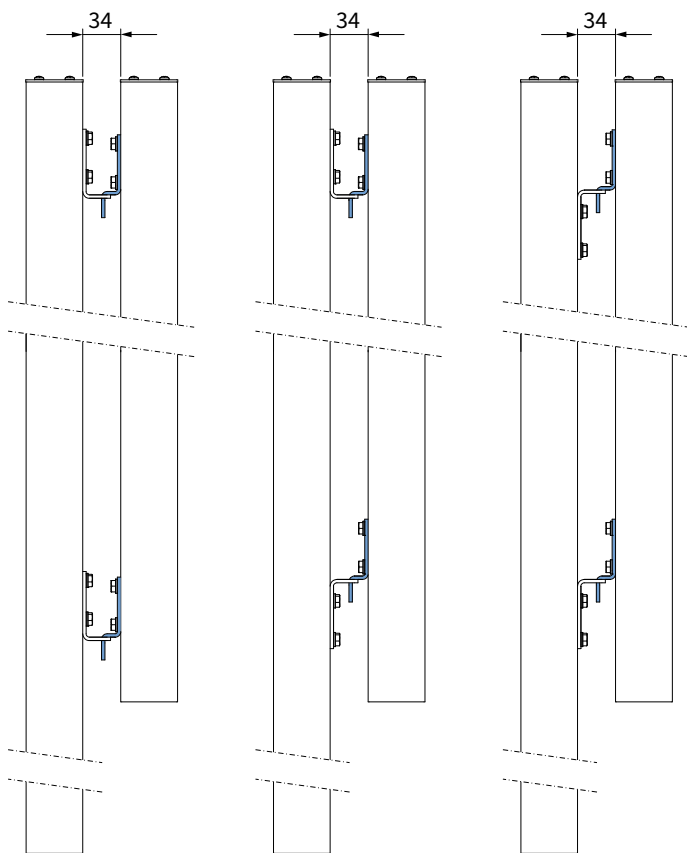

### Locked installation

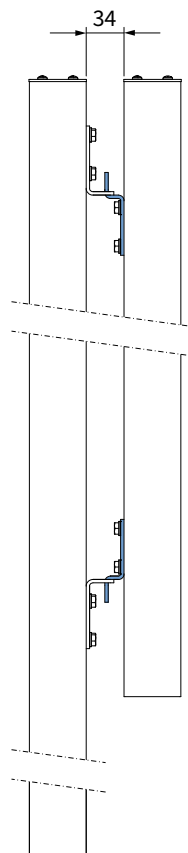

Figure 2.6 Location wall linking



## Installation

Follow below steps for installation:

1. Dismount the covering caps at the topside of the windscreen and loose upright.
2. Mount the coupling block (a) loosely to one side of the bracket (b). Do this for all four brackets. Slide two coupling blocks in the slot of the windscreen and two in the slot of the loose upright. The way depends on the way you want to link, see the possibilities in figure 2.6 at page 13. Determine the exact height at which the coupling blocks must be screwed. Tighten the screws.
3. Hook the brackets of the windscreen into those of the loose upright. The windscreen is now linked.
4. Mount the covering caps at the topside of the uprights.

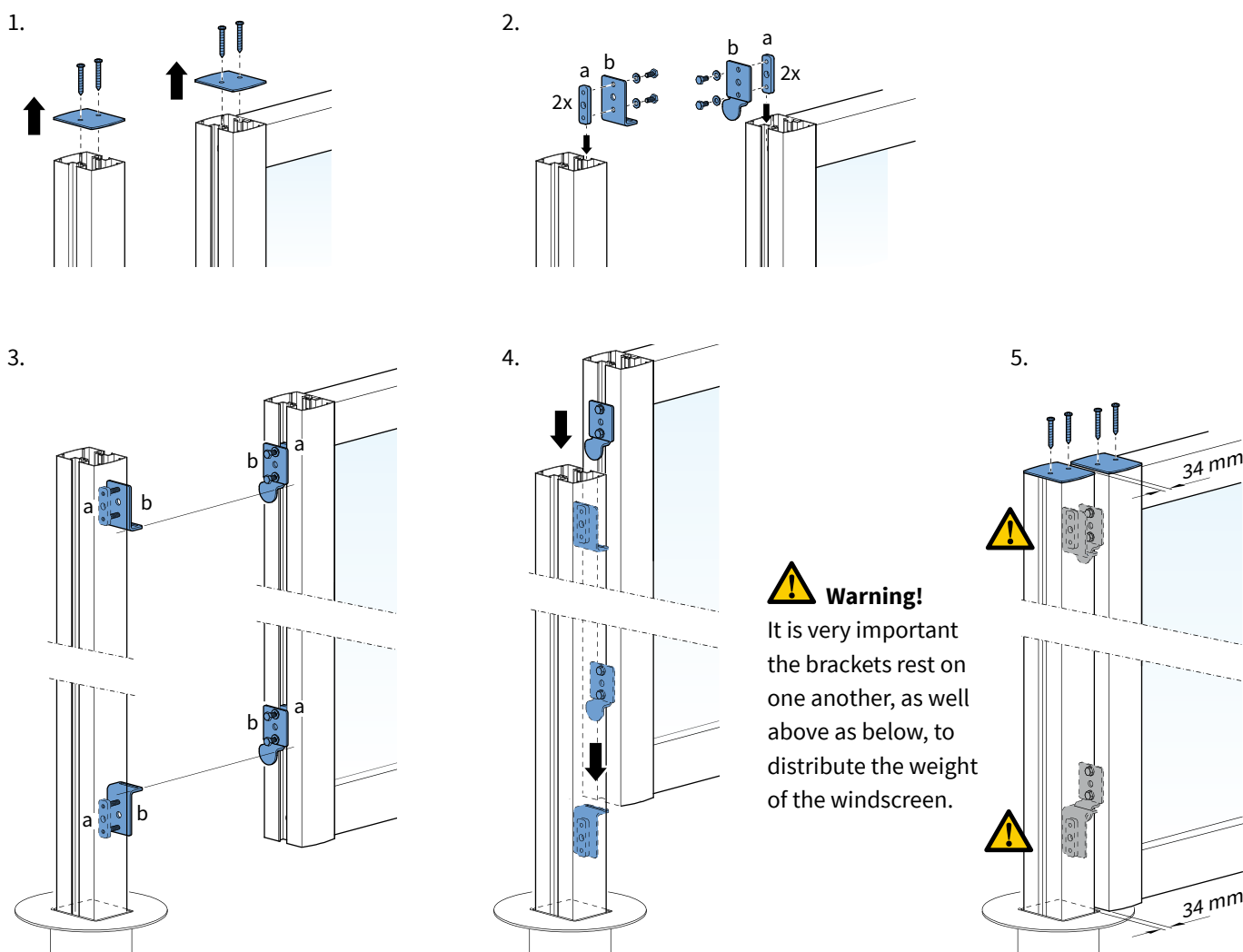

Figure 2.7 Installation linking hook

### 3. Accessoires

#### 3.1 Hinge

The advantage of installation a hinge in between two windscreens, is the fact that you can place your windscreen in any required angle, ranging between 90° and 180°.

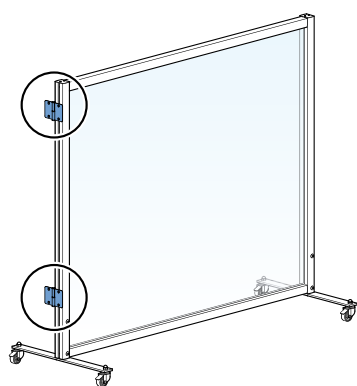

Figure 3.1 Location hinge

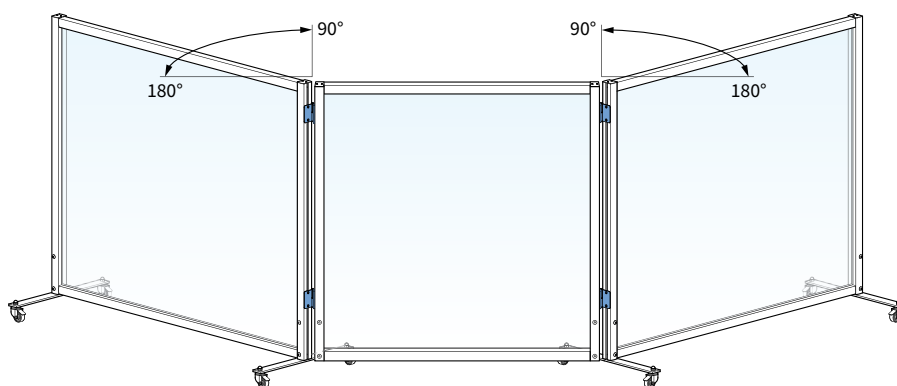

Figure 3.2 Installation in angle ranging between 90° and 180°

Follow below steps for installation:

1. Mount the coupling block (a) loosely to one side of the hinge (b). Do this with both hinges.
2. Slide both hinges with the coupling block into the slot of the windscreen. One hinge at the bottom and one hinge at the top.
3. Tighten both hinges firmly.
4. Slide a coupling block at the bottom of the other upright and hold this in its place at the bottom hinge.
5. Screw the other side of the hinge onto it. Do the same for the top hinge.

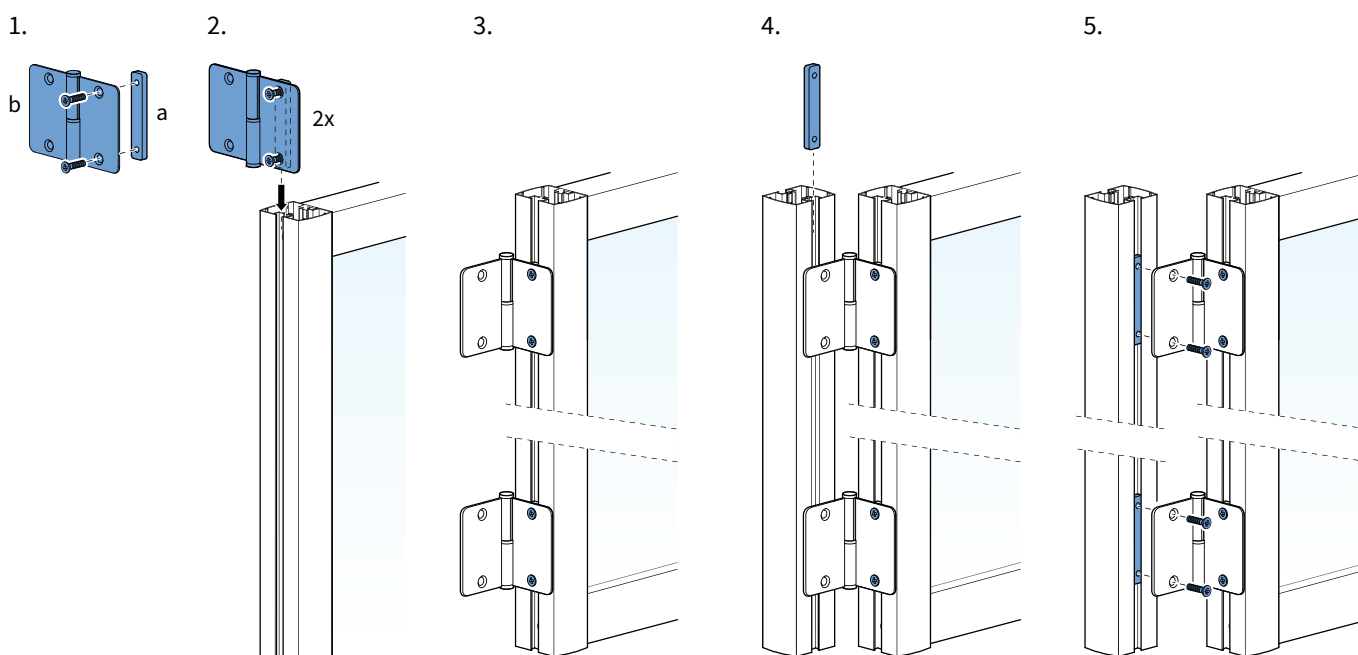
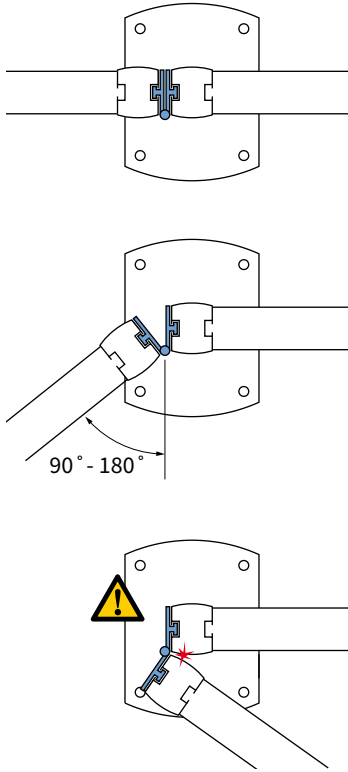

Figure 3.3 Installation hinge

The installation of a hinge is possible with any type of Biarritz. In the drawing below you can see the top view of the use of a hinge with standard linking (windscreen – windscreen) and profile linking (windscreen – separate upright – windscreen).

#### Standard linking



#### Profile linking

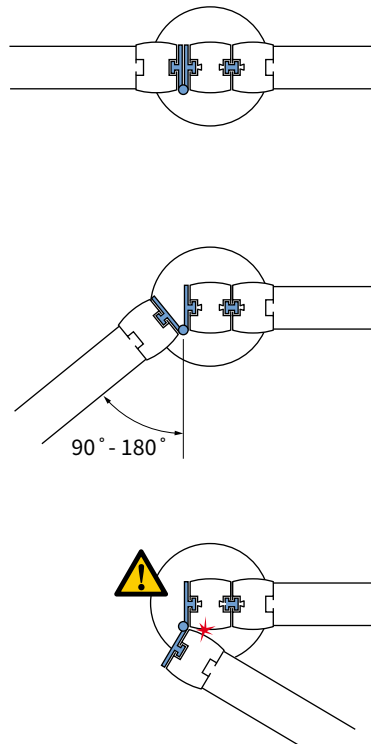

#### Warning!

When you bend the windscreen to far you can damage the uprights.

Figure 3.4 Hinge top view

## 3.2 Wall installation

The Biarritz windscreen can be attached to a wall by using a wall strip and brackets.

Wall installation is ideal as a temporarily installation in combination with portable Biarritz windscreens. But also with fixed footplates can the windscreen be mounted to a wall by using a wall strip.

You can decide yourself if you do or don't want a foot at the wall side.

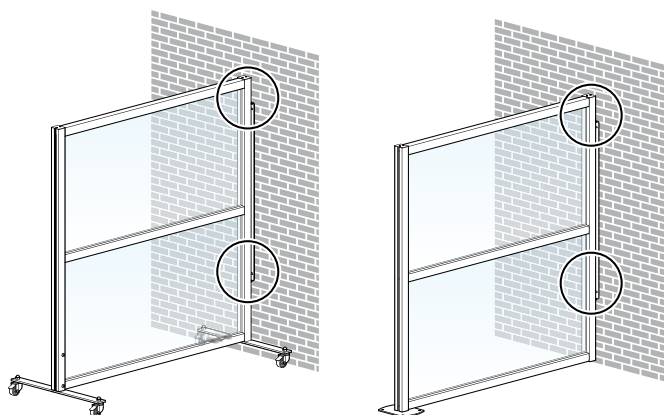

Figure 3.5 Location wall linking

Follow below steps for installation:

1. Determine the height at which the wall strip should be mounted and mount the wall strip to the wall with two plugs and screws.
2. Measure the exact height at which the brackets on the windscreen should be screwed.

You can chose for **detachable installation** or **locked installation**.

For installation of the brackets see figure below and explanation on page 14.

### Detachable

### Locked

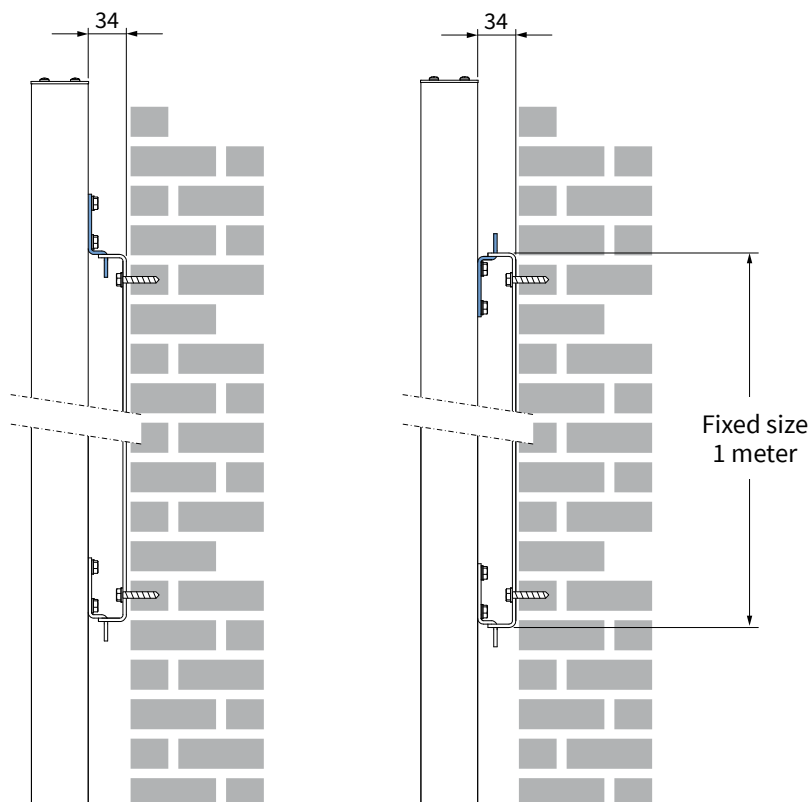

Figure 3.6 Location wall linking

### 3.3 Handle

The installation of a handle on your Biarritz windscreen can be very convenient when you have to move the windscreen on a regular basis.

Follow steps below for installation:

1. Slide two coupling blocks (a) in the slot of the windscreen.
2. Mount the handle at the required height onto the coupling blocks (a) with two screws.

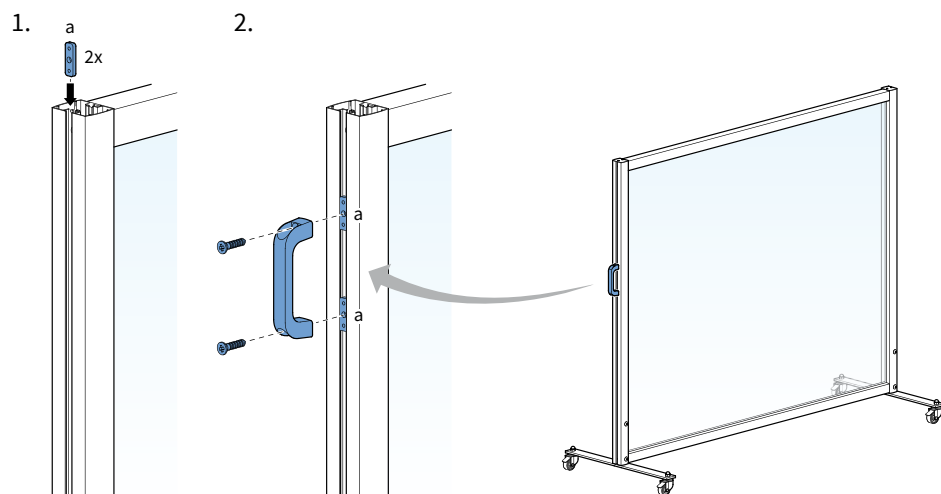

Figure 3.7 Installation handle

### 3.4 Ground lock

A ground lock, also known as drop bolt, is an extra lock on your portable windscreen. It also provides more stability.

Follow below steps for installation:

1. Slide the coupling blocks (a) into the slot of the windscreen.
2. Mount the brackets (b) onto the coupling blocks (a) with included screws.
3. Place the tube (c) firmly into the subsurface, where the windscreen should be placed and locked. By 'dropping' the bar (d) into the tube your windscreen will be locked.

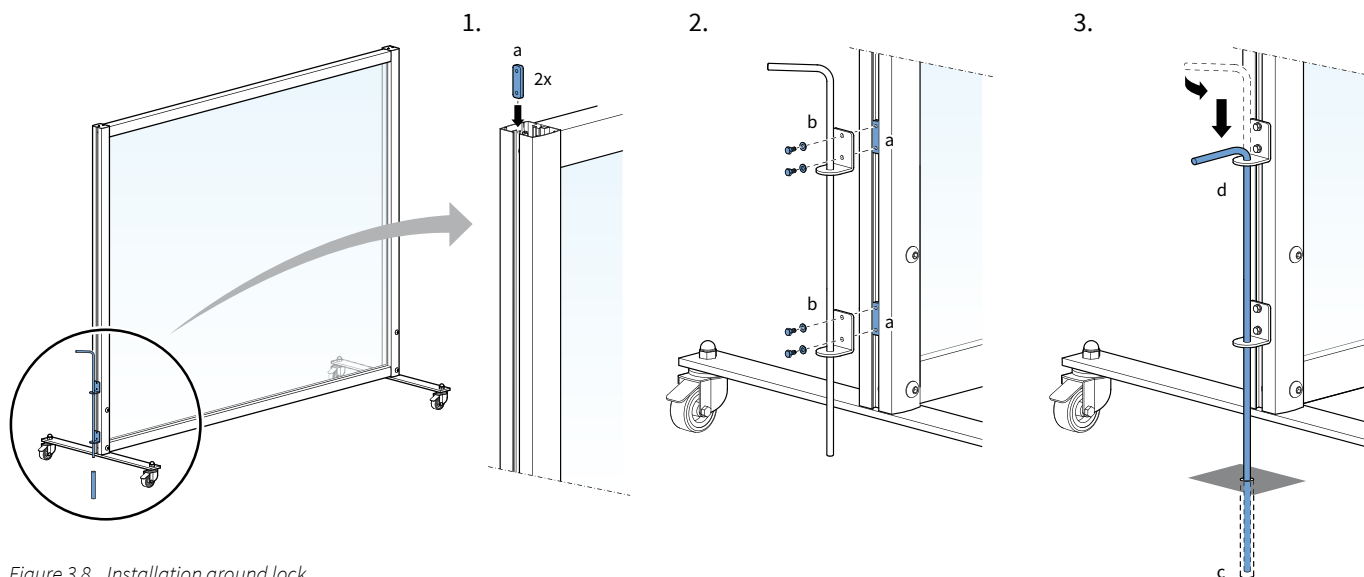
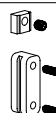
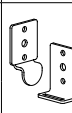
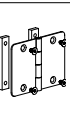

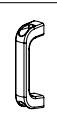
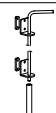









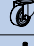

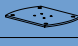





Figure 3.8 Installation ground lock

## 4. Possibilities overview Biarritz

					Type			Linked		Accessoires				
					variable size w = 1000 - 3500 H = 1000 - 2500  1-part (28.731) 2-parts (28.732) 3-parts (28.733)	Fixed size W = 2000 mm H = 1500 mm  2-part (28.735) 3-parts (28.736)	blind (set)	hook (set)	hinge (set)	wall installation	handle	ground lock		
Biarritz with	Installation				W ≤ 2500 H ≤ 1500	W > 2500 H > 1500								
feet	portable	showroom foot	round 200		○	×	○	○	○	○	×	○	×	
			round 300		○	×	○	○	○	○	×	○	×	
		basic foot	cap		○	×	○	○	●	○	○	○	○	
			wheels		○	×	○	○	●	○	○	○	○	
			wheels with break		○	×	○	○	●	○	○	○	○	
		raised foot	cap		○	×	○	○	●	○	○	○	○	
			wheels		○	×	○	○	●	○	○	○	○	
			wheels with break		○	×	○	○	●	○	○	○	○	
		reinforced foot	cap		○	×	○	×	●	○	○	○	○	
			wheels		○	×	○	×	●	○	○	○	○	
			wheels with break		○	×	○	×	●	○	○	○	○	
	fixed onground	ground footplate			○	○	○	●	○	○	○	×	×	
		wall footplate			○	○	○	●	○	○	○	×	×	
uprights	fixed inground	separate upright	straight		○	●	○	●	○	○	×	×	×	
			corner profile		○	●	○	●	○	○	×	×	×	
			T-profile		○	●	○	●	○	○	×	×	×	

● = Preference | ○ = Possible | × = Not possible